



LeafVac[®]

DEBRIS CONTAINMENT

Installation Instructions



A&A Manufacturing

Rev. 20191102

© Copyright 2019 A&A Manufacturing. All rights reserved.

IMPORTANT

Do not backfill around the LeafVac until after the pressure testing is done to ensure there are no leaks at the bottom union.

Do not over tighten unions.

NOTE:

The LeafVac canister is to be installed in the equipment area immediately in front of the pump.

The LeafVac comes with two union fittings (Figure 2), one for the inlet and another for the outlet. Each union fitting allows for a 2", 2.5" or 3" connection.

Union Fittings

The union fittings (Figure 1) supplied with the LeafVac allow the unit to be plumbed with 2" (Figure 2a), 2.5" (Figure 2b) or 3" (Figure 2c), depending on the suction line requirements designated on the A&A Manufacturing Design Layout.

The union fittings consist of three pieces, the union nut (Figure 1a), the union coupler (Figure 1b) and the union O-ring (Figure 1c). The inside of the union coupler is designed to accept 2.5" pipe, while the outside of the union coupler will accept a 3" pipe fitting (Figure 2c).

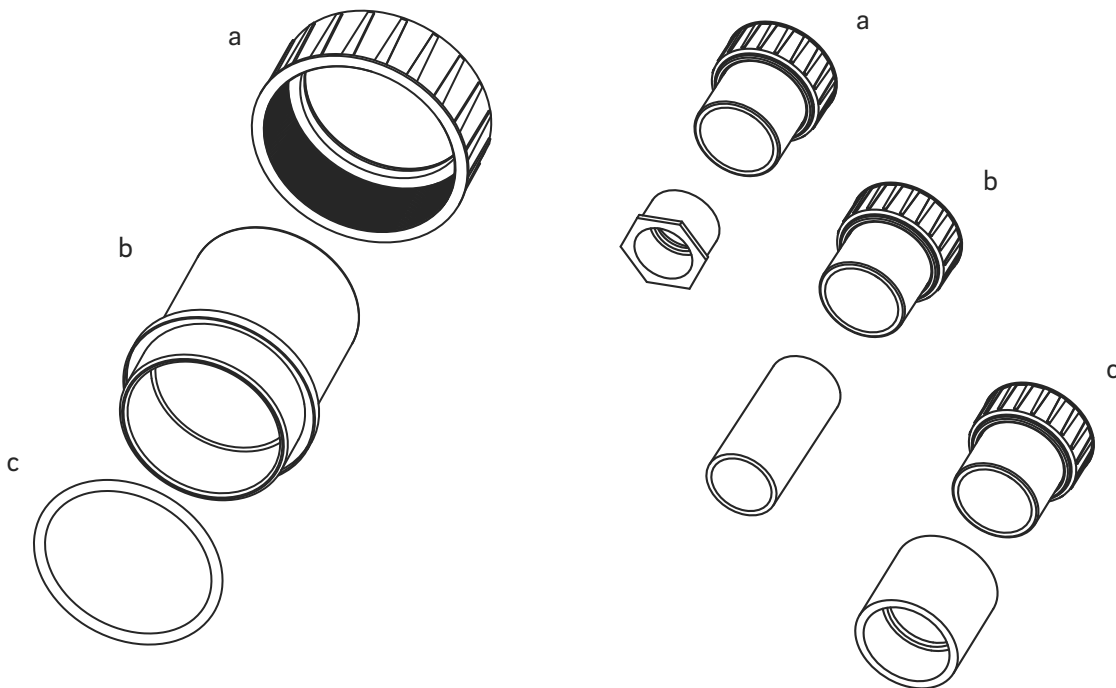

Figure 1

Figure 2

Plumbing

Using the A&A Manufacturing Design Layout, determine the size of the suction line required for the pool and run it to the equipment area.

Before plumbing begins, make sure that the unions are properly secured to the LeafVac and that the same size pipe is used on both inlet and outlet union fittings.

1. Begin by plumbing from outlet fitting at the bottom of the LeafVac canister to the suction side of the pump, keeping the bottom of the of the LeafVac lid approximately the same height as the pump lid (Figure 3b). It is highly recommended to use 90° sweep elbows, rather than standard 90° elbows. When making the connection between the LeafVac outlet fitting and the pump, always follow the plumbing guildines recommend by the pump's manufacturer.
2. Next, begin the plumbing of the union fitting on inlet side of the LeafVac to the suction line from the pool. When multiple suction lines are used, make sure that they are joined before the inlet side of the LeafVac. This may be accomplished by using a 3-way valve, equal in size or greater than the suction line being used. From this point, the multiple suction lines joined to the 3-way valve, allowing for a single pipe to enter the intlet of the LeafVac (Figure 3a).

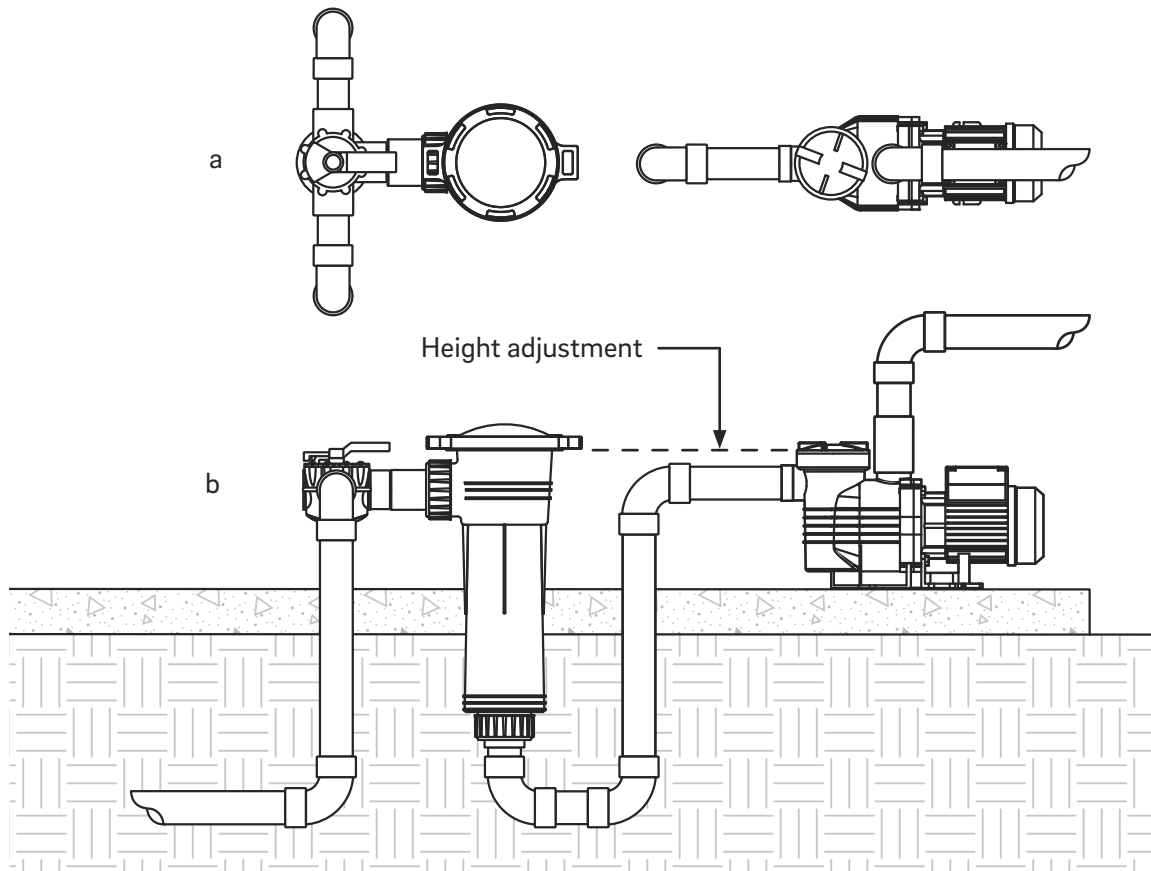

Figure 3